

⚠ Warning:

This toy is unsuitable for children under 3 years due to its maximum speed.

⚠ Warning:

Pay attention to the potential hazards of using the toy in areas other than private grounds.

Recommended protective equipment (helmet, gloves, knee-pads, elbow-pads, etc.).

-This Toy Contains battery that is not replaceable(For vehicle)

-The transformer, power supply or battery charger used with the electric toy shall be regularly examined for damage to the supply cord, plug, enclosure or other parts, and in the event of damage, it shall not be used until the damage has been repaired.

⚠ Warning:

The remote control is not a toy. It is for the adult use only, and should not be used by a child. A close adult supervision is always required. Reception range may change significantly with weather, battery, and other environmental conditions.

If the product has an uncontrolled mode, then the instructions for use shall also include an explanation detailing all possible methods of switching the system from controlled mode to uncontrolled mode.

Fire Truck (L911Pro)

battery powered ride-on

Owner's manual with assembly instructions



Read and understand this entire manual before using!
Please keep this manual for future reference as it contains important information.
Before first time use, charge the battery for at least 8- 12 hours.

1 . About Your New Vehicle

battery powered ride-on
Owner's manual with assembly instructions

SPECIFICATIONS:

Age :	37-95months
Load limit :	25kgs
Battery :	6V7Ah/12V4.5Ah/12V7Ah/24V5Ah
Speed :	2.5-8km/h
Motor :	6V PRM-15000/12V PRM-15000/24V PRM-15000
Protector :	4A-20A
Charger :	6V500mA/12V500mA/12V1000mA/24V1000mA/28.8V800mA
Charging time :	8-12h
Size :	86.5X50.5X34.5CM

BATTERY INFORMATION

- Non-rechargeable batteries are not to be recharged.
- If removable rechargeable batteries are used, they are only to be charged under adult supervision.
- Remove rechargeable batteries from the product before charging.
- Do not mix old and new batteries. Do not mix different types of batteries: alkaline, standard(carbon-zinc) or rechargeable (nickel-cadmium).
- Insert batteries as indicated inside the battery compartment, anode to anode, cathode to cathode.
- Remove batteries during long periods of non-use. Always remove exhausted batteries from the product. Battery leakage and corrosion can damage this product. Dispose of batteries safely.
- Never short circuit the battery terminals.

21.Troubleshooting Guide

Problem	Possible Cause	Solution
Vehicle does not run	Battery low on power	Recharge battery.
	Thermal fuse has tripped	Reset fuse, see <Fuse>
	Battery connector or wires are loose	Check that the battery connectors are firmly plugged into each other. If wires are loose around the motor contact your distributor please.
	Battery is dead	Replace battery, contact your distributor please.
	Electrical system is damaged	Contact your distributor please.
Vehicle does not run very long	Motor is damaged	Contact your distributor please.
	Battery is under charged	Check that the battery connectors are firmly plugged into each other when recharging
Vehicle runs sluggishly	Battery is old	Replace battery, contact your distributor please.
	Battery low on power	Recharge battery, contact your distributor please.
	Vehicle is overload	Reduce weight on vehicle. Maximum user weight is 30 kgs.
Vehicle needs a push to go forward	Vehicle is being used in harsh conditions	Avoid using vehicle in harsh conditions ,see <Safety>.
	Poor contact of wires or Connectors	Check that the battery connectors are firmly plugged into each other. If wires are loose around the motor, contact your distributor please.
Difficult shifting from forward to reverse or vice-versa	"Dead Spot" on motor	A dead spot means the electric power is not being delivered to the terminal connection and the vehicle needs repair. Contact your distributor please.
	Attempting to shift while the vehicle is motion	Completely stop the vehicle and shift, see <Use Your New Vehicle>
Loud grinding or clicking noises coming from motor or gear box	Motor or gears are damaged	Contact your distributor please.
	Battery connector or adapter connector is loose	Check that the battery connectors are firmly plugged into each other.
	Charger not plugged in	Check that the battery charger is plugged into a working wall outlet.
Battery will not recharge	Charger is not working	Contact your distributor please.
	Charger feels warm when recharging	This is normal and not a cause for concern

Completely read through this manual and the troubleshooting guide table before calling. If you still need help resolving the problem **Contact your distributor please.**

20.Fuse & Maintaining

Protector

This product is equipped with a self-resetting protector. When overloaded or improperly used, the self-resetting protector will automatically cut off the power for 5-20 seconds, and then restart. The self-resetting protector of this car is installed under the seat.

To avoid losing power, follow these guidelines:

- Do not overload the vehicle.
- Do not tow anything behind the vehicle.
- Do not drive up steep slopes.
- Do not drive into fixed objects, which may cause the wheels to spin, causing the motor to overheat.
- Do not drive in very hot weather, components may overheat
- Do not allow water or other liquids to come in contact with the battery or other electric components.
- Do not tamper with the electric system. Doing so may create a short, causing the fuse to trip.

Maintaining

- It is parents' responsibility to check main parts of the toy before using, Must regularly examine for potential hazard, such as the battery, charge, cable or cord, plug, screws are fastening enclosure of other parts and that in the event of such damage, the toy must not be used until that damage had been properly removed.
- Make sure the plastic parts of the vehicle are not cracked or broken.
- Occasionally use a lightweight oil to lubricate moving parts such as wheels.
- Park the vehicle indoors or cover it with a tarp to protect it from wet weather.
- Keep the vehicle away from sources of heat, such as stoves and heaters. Plastic parts may melt.
- Recharge the battery after each use. Only an adult can handle the battery. Recharge the battery at least once a month when the vehicle Raider is not being used.
- Do not wash the vehicle with a hose. Do not wash the vehicle with soap and water. Do not drive the vehicle in rainy or snowy weather. Water will damage the motor, electric system and battery.
- Clean the vehicle with a soft, dry cloth. To restore shine to plastic parts, use a non-wax furniture polish. Do not use car wax. Do not use abrasive cleaners.
- Do not drive the vehicle in loose dirt, sand or fine gravel which could damage the moving parts, motors or the electric system.
- When not using, all the electrical source should be turned off. Turn off the power switch and disconnect the battery connection.

2. Part List

NO.	PART NAME	QTY(PCS)		REMARK
		2WD	4WD	
1	Car body	1	1	
2	Front wheel	2	2	
3	Seat	1	1	
4	Wheel cover	4	4	
5	Charger	1	1	
6	Steering wheel	1	1	
7	Motor	2	4	
8	Alarm lamp	1	1	
9	Water gun	1	1	
10	Water tank	1	1	
11	Water tank cover	1	1	
12	Water tank clamp	1	1	
13	Water gun clamp	1	1	
14	Tool clamp	2	2	
15	Tool	2	2	
16	Remote control	1	1	
17	Manual	1	1	
18	Spanner	2	2	
19	Back wheel	2	2	
20	Interphone	1	1	

A	4x12 Self-tapping screw	6	6	
A-1	4x14 Self-tapping screw	2	2	
B	M10 Washer gasket	6	6	
C	Washer screw	1	1	
D	Steering screw	1	1	

3.Parts Diagram

NOTE:Some parts shown are assembled on both sides of vehicle

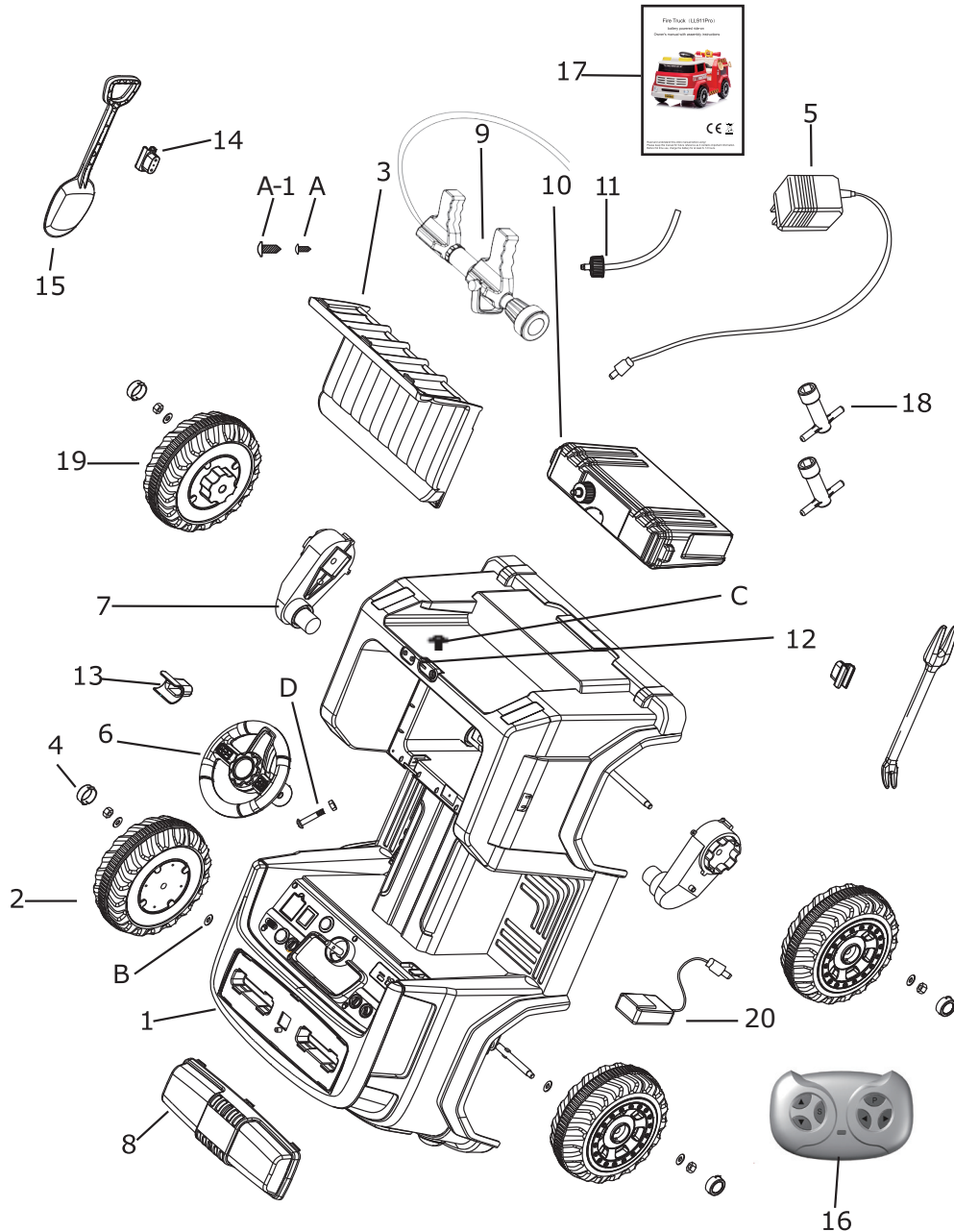

18.Music Player Function

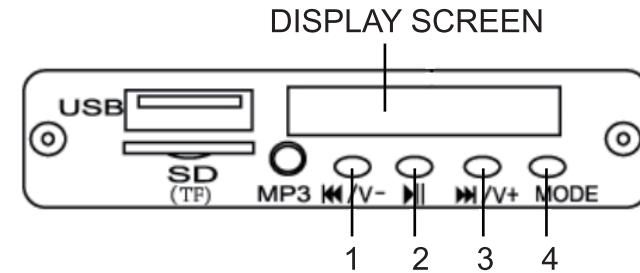

- Button 1: Voice reduce and cut for next song, press 1 second is cut for next song Long press about 3 seconds is reduce the music voice.
- Button 2: Pause button, click is suspend play music, when press the return to playmode again.
- Button 3: Voice increase and cut for last song, press 1 second is cut for last song Long press about 3 seconds is increase the music voice.
- Button 4: Pattern, on the USB plug have U disk, SD card is inserted in the inside. MP3 also insert, click in this button will turn to the next. Whether the USB or SD or MP3, finally play music after insert is Preferred to read card.

19.Charging

⚠ WARNING!

- ONLY an adult is allowed charge and recharge the battery!
- This product with Charging Protection: when charging, all functions will be cut off.

- The POWER SWITCH must be turned in OFF position when charging.
- Before the first use, you should charge the battery for 4-6 hours. Do not recharge the battery for more than 10 hours to avoid overheating the charger.
- When the vehicle begins to run slowly, recharge the battery.
- After each use or once a month minimum recharge time as 8 to 12 hours. less than 20 hours at most.
- Use the only rechargeable battery and charger supplied with your vehicle. NEVER substitute the battery or the charger with another brand. Using another battery or charger may cause a fire or explosion.
- Do not use the battery or charger for any other product.

16. Charging

1. Insert the charger plug into the charging hole on the left side of the car seat as shown below.
2. Insert the charger power plug into a stable and matched AC power source as shown in the figure.

Note when charging: To ensure safety, the car must be charged by an adult. For details, please see (Things to know before charging)

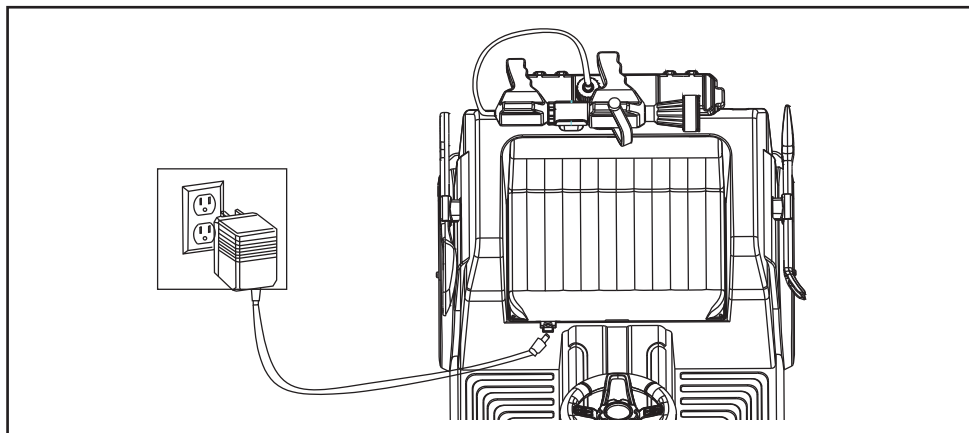

17. Use Your New Vehicle

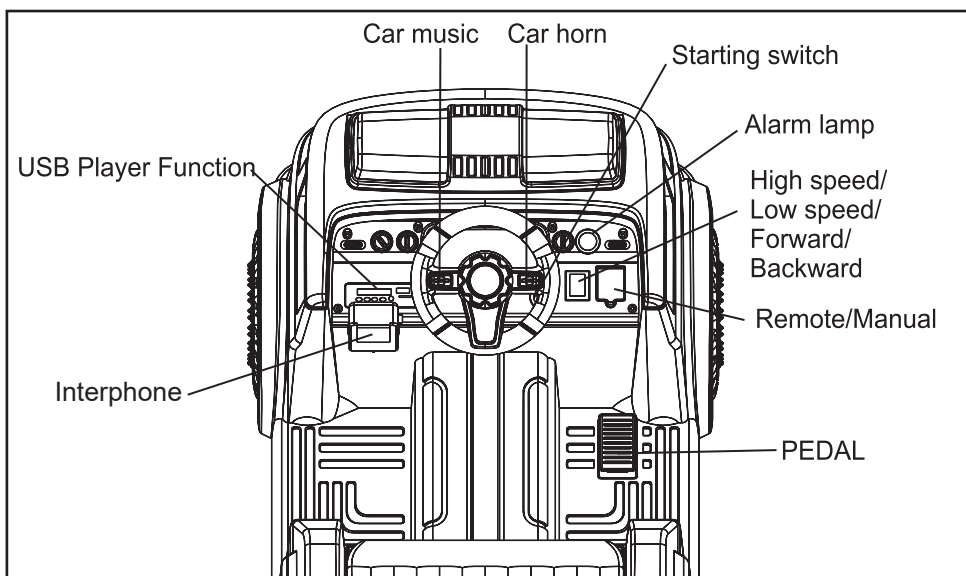

4. Safety



PREVENT INJURIES AND DEATHS:

- NEVER LEAVE CHILD UNATTENDED. ADULT DIRECT SUPERVISION IS REQUIRED. Always keep child in view when child is in vehicle.
- This toy should be used with caution since skill is required to avoid falls or collisions causing injury to the user or third parties.
- Protective equipment should be worn.
- Never use in roadways, near cars, on or near steep inclines or steps, swimming pools or other bodies of water.
- Always wear shoes, always sit on the seat.
- Not to be used in traffic.
- This toy is unsuitable for children under 37 months due to its maximum speed; Maximum userweight is 25 kgs.
- This toy has no brake.



WARNING:

- CHOKING HAZARD! Not suitable for children under 37 months.
- ADULT ASSEMBLY REQUIRED.

Rules for Safe Riding

- Use the toy only on flat surfaces. Such as inside your house, garden or playground.
- Never use in the dark. A child could encounter unexpected obstacles and have an accident. Operate the vehicle only in the daytime or a well-lit area.
- It is prohibited to change the circuit or add other electric parts
- Inspect wires and connections of the vehicle periodically.
- Do not let any child touch the wheels or be near them when the car is moving.
- This vehicle has adjustable play seat belts. Please instruct children how to tie the safety belt before using, guarantee the security.
- To reduce the risk of injury, adult supervision is required. Never use on roadways, near motor vehicles, on or near steep inclines or steps, swimming pools or other bodies of water; always wear shoes, and never allow more than one rider.

5. Attach the front wheel

Dual drive

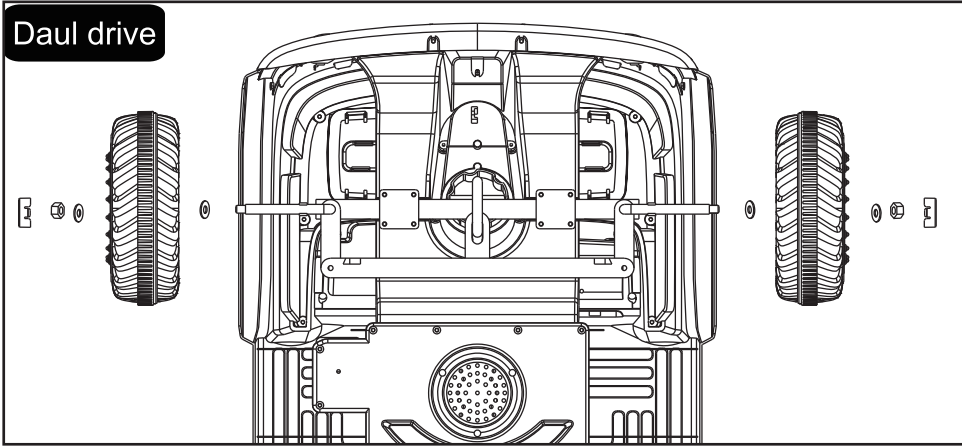

1. Install a M10 washer gasket on the front axle;
2. Load the wheels;
3. Install another M10 washer gasket;
4. Use a wrench to secure the M8 nut;
5. Clip into the wheel cover decoration Install the other side in the sameway.

6. Attach the rear wheel

Dual drive/Four-wheel drive

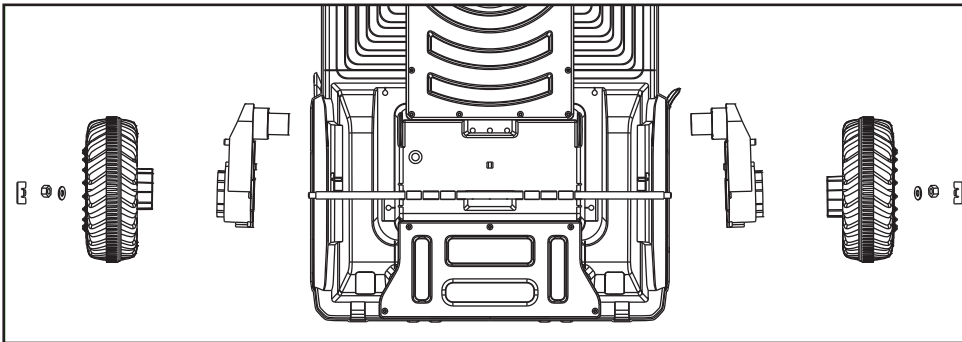

1. Install the drive motor;
2. Install a gasket;
3. Fix with a wrench nut;
4. Clip into the wheel cover decoration Install the other side in the same

15. Use the Remote Controller

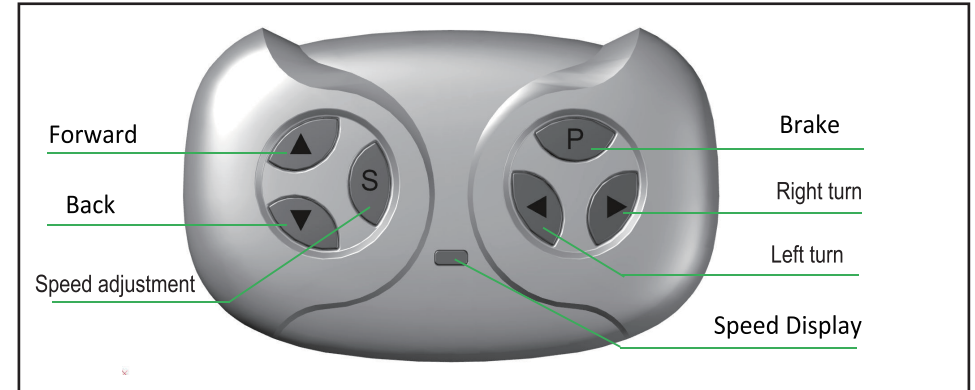

The remote control has precedence over foot pedal operation. (The foot pedal won't work while you operate the Remote Controller)

ASSEMBLY

Lift the battery compartment door on the back of the controller and insert two AAA(LR03) batteries.

NOTE: This product did not included the AA(LR6) batteries. Follow the battery information on page 1.

1. Connection button

Long press the forward and back button for 2~4 seconds first; Then turn on the power button located on the vehicle dashboard console, when the status indicator flashes, means the connection successful. If the status indicator no response, means the connection failed. Replace the batteries and repeat the steps above and try again.

2. Brake button

Press the button to stop the vehicle, press it again to release the brake.

3. Speed select button

The switch operates the vehicle to move in low, normal or high speed.

HINT: The vehicle is designed to operate in low speed only in reverse.

NOTE:

·Leave the remote controller idling for about 10 seconds, it will shut down automatically.

·Repeat step 1 when you replace the batteries of the remote controller.

13.Connection of water gun and water tank

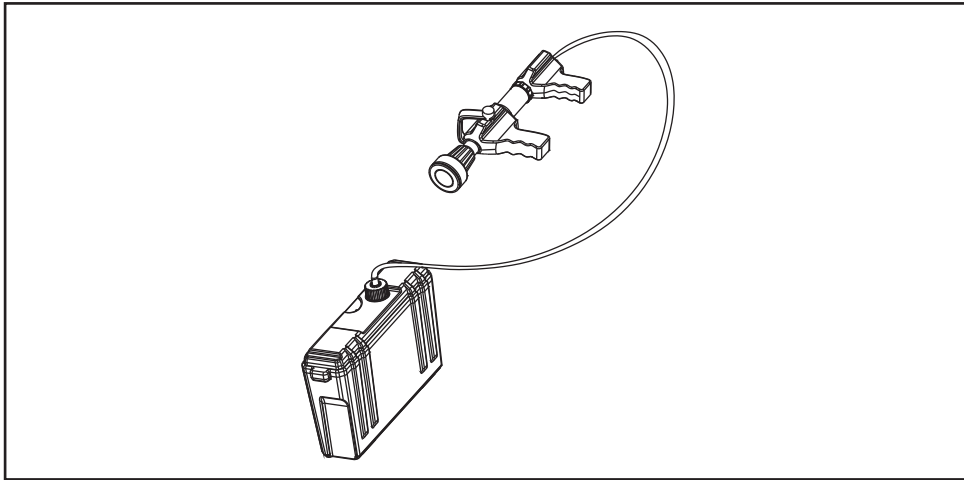

Connect the hose on the water gun to the tank cover on the water tank and tighten it

14.Installation of tools

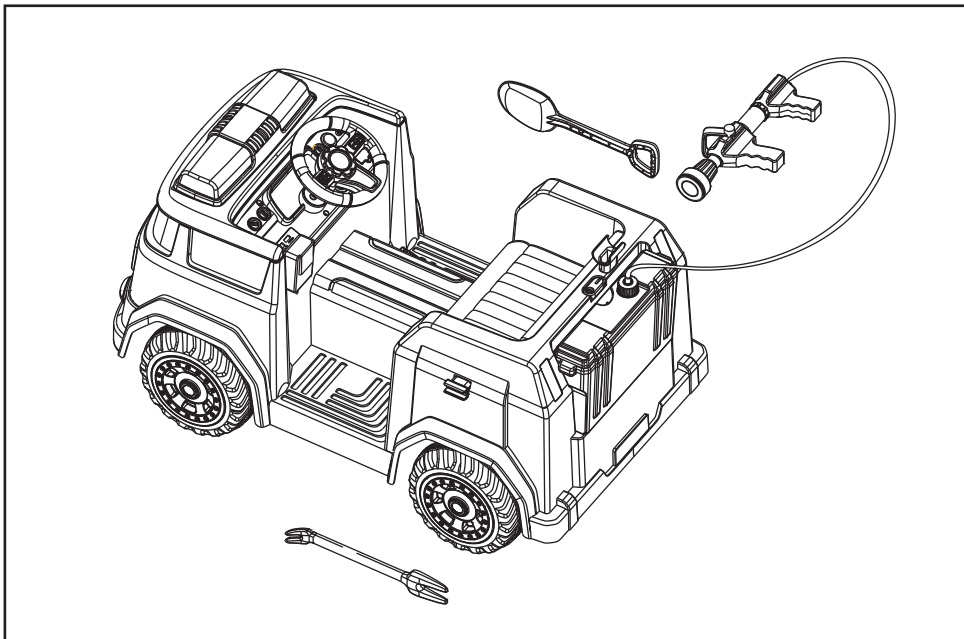

1、 Place the tool in the card 2、 Connect the water gun pipe to the tank cover

7.Alarm light installation and connection

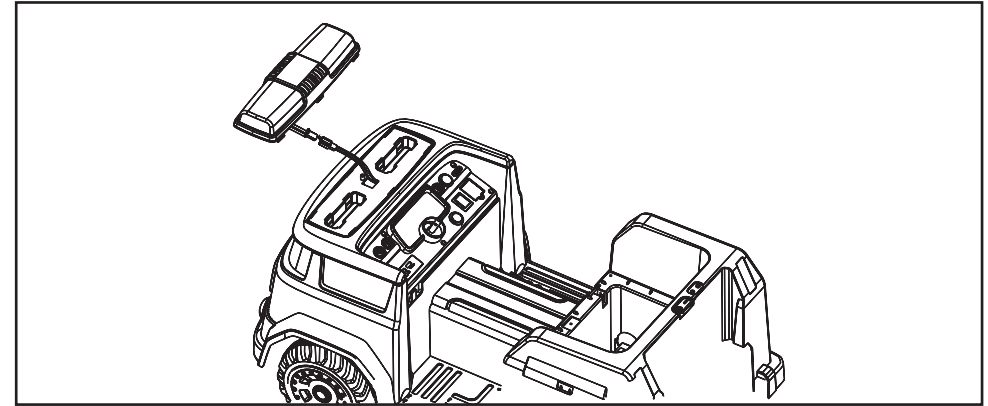

- 1.Connect the music plug-in on the Alarm light with the music plug-in on the front of the car , and then put the plug-in into the hole.
- 2.Install the alarm light on the front of the car

8.Steering wheel installation

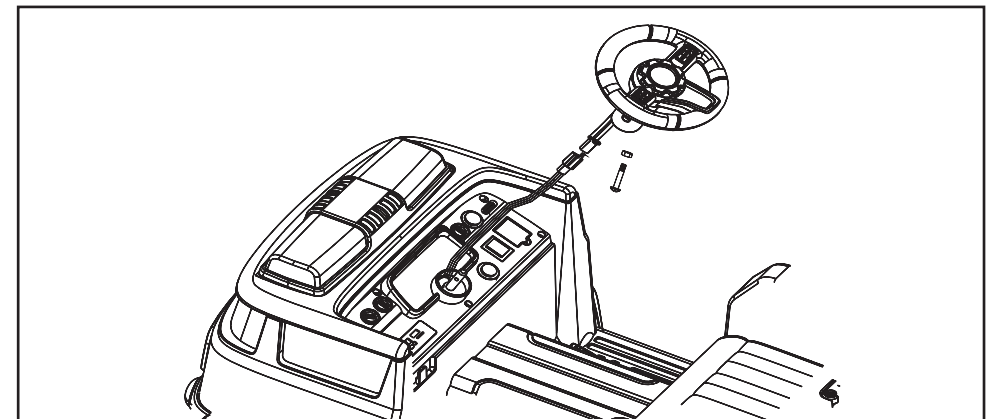

- Turn the vehicle over so that the front is facing up:
- 1.Connect the music plug-in on the steering wheel with the music plug-in next to the steering bar, and then put the plug-in into the hole on the underside of the steering bar of the dashboard.
 2. Insert the steering wheel. into the end of the steering rod, pay attention to the front and back of the steering wheel.
 3. Put the M5 nut into the hole and insert the M5*30 screw into the hole.

9. Motor and battery connection

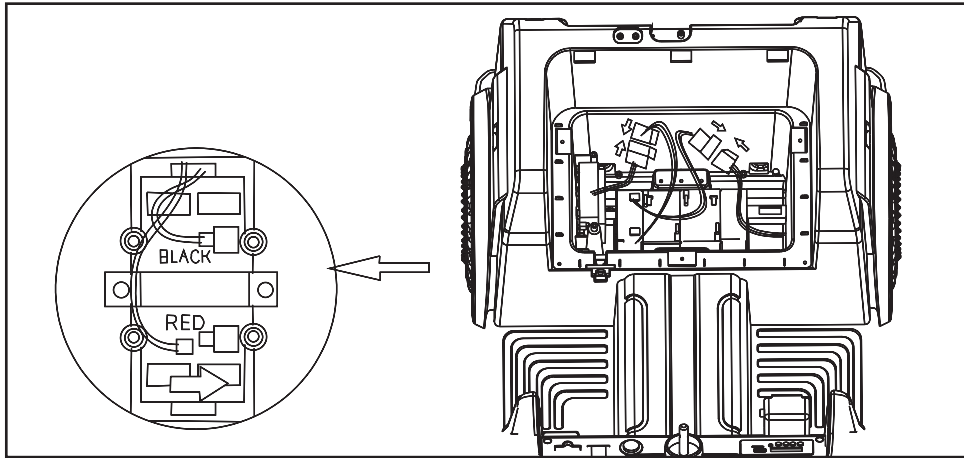

Note: When connecting the battery wire, insert the red wire into the red terminal and the black wire into the black terminal;
Pay attention to the left and right points when inserting the motor wires in pairs.

10. Seat installation

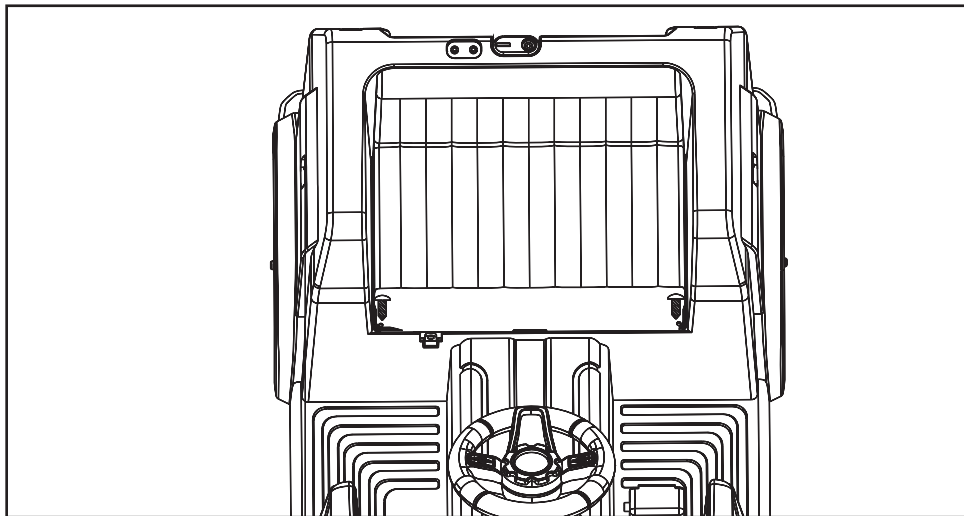

Use 2 screws to fix

11. Water tank installation And Intercom connection

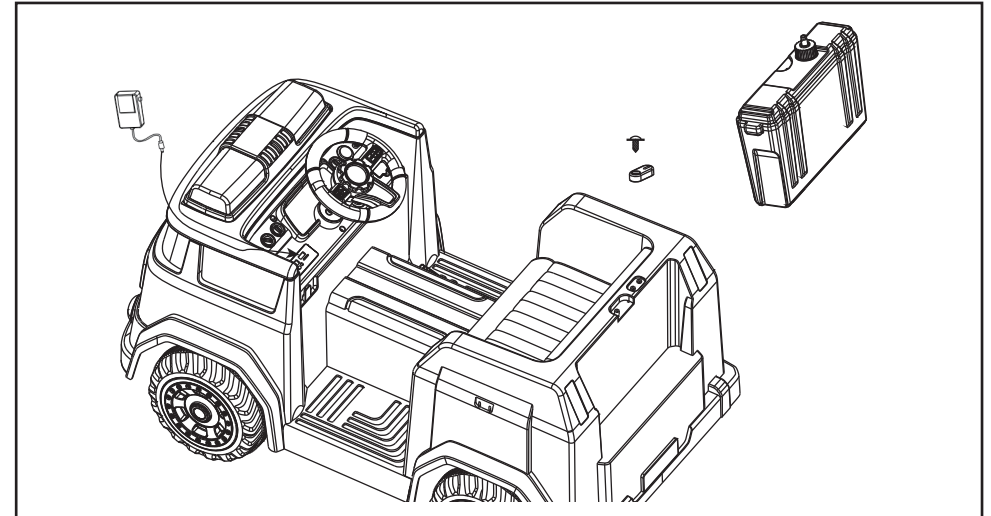

1. Secure the water tank clamp with washer screws
2. Insert the water tank into the card slot
3. Screw the water tank cap onto the water tank
4. Align and load the walkie-talkie

12. Installation of water guns and tools

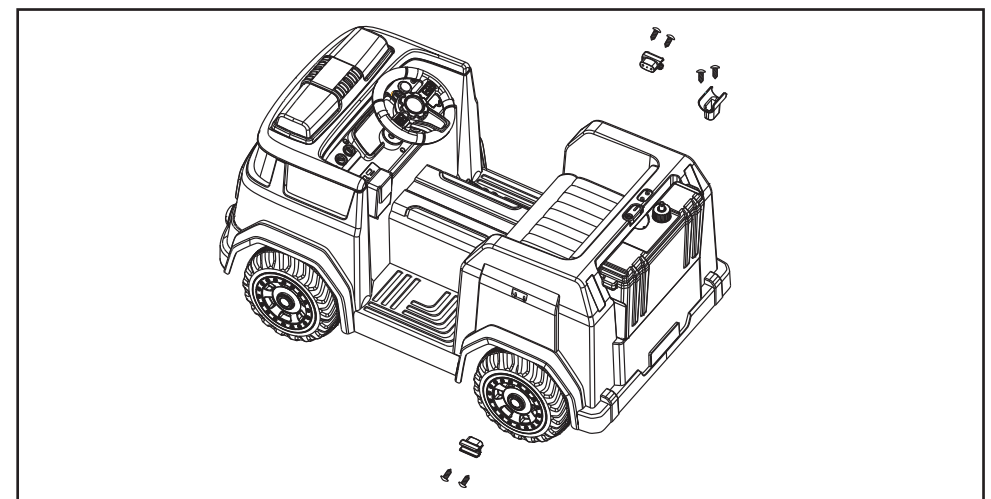

1. Use 4×12 self-tapping screws to secure the clamp.
2. Put the water gun and tools on
3. Connect the water gun to the water tank cover