

RAM 1500 RHO

BATTERY-OPERATED RIDE ON CAR

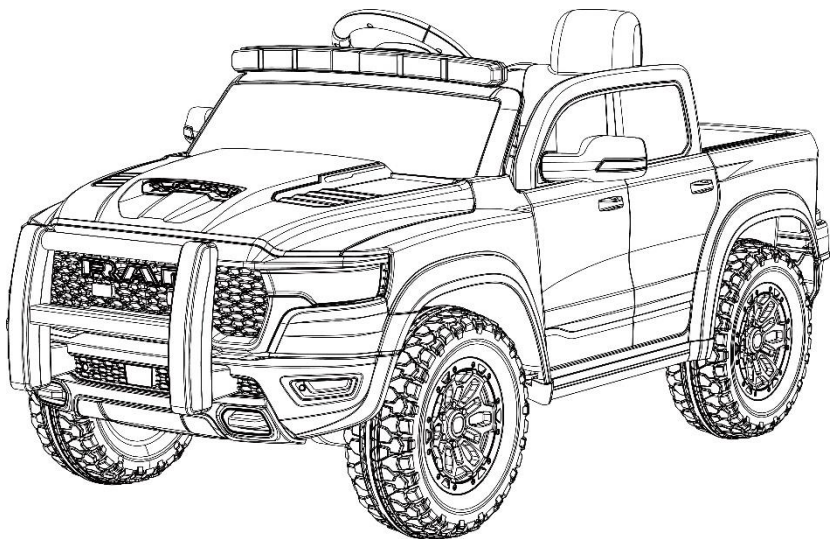

Type B: ZB618P
(Police Truck Version)

User Manual

with Assembly Instructions

Styles and colo(u)rs may vary.
Made in China.

Warning! The Ride-on Car must be assembled by an adult who has read and understands the instructions in this manual.
Keep the package away from children and dispose of properly before use.
Keep this manual for future reference.

Dear Customer,

We'd like you to make the best use of our product with safety and enjoyment. Please read the entire user manual carefully before you use the product. It shows the correct method of installation, operating procedures, warnings and safety notes to help assure you and your rider a safe ride. Please keep it for future reference.

RAM and related logos, vehicle model names and trade dress are trademarks of FCA US LLC and used under license by Shanghai Zhenbao Industrial Co., Ltd.. ©2024 FCA US LLC.

Manufacturer: Shanghai Zhenbao Industrial Co., Ltd.
 Address: Room 102, XinFeng Highway Road#4972,
 Fengxian District, Shanghai, China
 Web: www.zhenbaosh.com

SPECIFICATIONS:

Battery	12V4.5AH*1	or 12V7AH/ or 12V/10AH/ or 24V
Charger	12V500MA*1	or 12V1000mA / or 24V

Suitable age: 37-96 months

Load Capacity: Under 30kg

Speed: 2-6 km/h

Size of car: TYPE B: 119 x 68 x 57 CM (With Bumper)

Power way: Charging type

Charge time: 8-12 hours

Remote control frequency: 2.4GHz

Kind notes: Functions may vary with different model and setting; Please adhere to the original products as standard.

 WARNING!

The following safety hazards may result in serious injury or death:

- **CHOKING HAZARD** - Small parts. Not suitable for children under 37 months. The product contains small parts, keep out of children's reach for all parts and packings and dispose of all packaging before use. **ADULT ASSEMBLY REQUIRED.** Any child must be supervised by adult while using the product and such the adult caregiver should not leave during driving process.
- Personal protective equipment should be worn. Always wear shoes & helmet and sit in the seat fixed by safety belt properly when operating the vehicle.
- This toy should be used with caution since skill is required to avoid falls or collisions causing injury to the user or third parties. Adults must teach their children around safe driving procedures.
- Not to be used in traffic. To reduce the risk of injury, adult supervision is required. Never use in roadways, near motor vehicles, on or near steep inclines or steps, swimming pools or other bodies of water; Warning! Pay attention to the potential hazards of using the toy in areas other than private grounds
- Never use in unsafe conditions such as snow, rain, loose dirt, mud, sand, lawn or gravel, otherwise may result in an unexpected accident such as tipping over, and could damage the electrical system or battery.
- The vehicle maximum load weight is 30kg, and never allow more than one rider.
- This toy has no brake; It is not recommended to drive the vehicle on wet surface or on slope greater than 15-degree. It is recommended to drive this vehicle on smooth surface only. Keep your hands, feet, hair, a body part or loose clothing away from moving parts.
- It is prohibited to short circuit or change the electric circuit system which may cause a shock, fire or explosion and permanently damage the system. Inspect all wires and connection of the vehicle periodically.
- Never open the battery. Battery posts, terminals and related accessories contain lead and lead compounds (acid) chemicals which are toxic and corrosive.

SAFETY PRECAUTIONS! WARNING!

1. Check the seat to ensure it has been fitted and secured with a screw before driving. In order to avoid accidents, please ensure the vehicle is safe before driving. Please watch fingers when opening and closing doors.
2. Clean the vehicle with a dry cloth only.
3. Children under 3 years of age cannot use the vehicle. Only drive on level ground. Do not go near swimming pools or other bodies of water, drop-offs or up and down steep inclines. Do not drive the vehicle into loose dirt, mud, sand or fine gravel. Do not drive the vehicle on streets or near cars.
4. Make sure that the vehicle stops completely before changing direction from forward to reverse. Please turn the power off when not in use.
5. Don't allow children to operate the charger or play with the battery. Charging the battery should only be done by adults. Charging plug is located underneath the seat.

Parts diagram of Type B | 3

Car body 1pc	Windshield 1pc	Steering wheel 1pc	Seat 1pc
Motors 2pcs	Manual 1pc	Upper windows 2pcs	Remote control 1pc
Mirrors 2pcs	Charger 1pc	1 Bag wheel cover rims 4pcs (Silver)	1 Bag wheel covers 4pcs (Black)
Front wheels 2pcs	Rear wheels 2pcs (notes: With torx coupling block)	1 Bag of screws & washers	Notes: The nuts are on the axles and steering wheel.
Kind notes: the Bumper and Microphone are Extra Options for police truck version.			

TOOLS REQUIRED

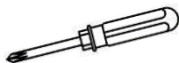

SCREW DRIVER
(BRING YOUR OWN)



M10 WRENCH 2PCS
(PROVIDED)

Type B: ZB618P (Police Truck) (Exploded Views)

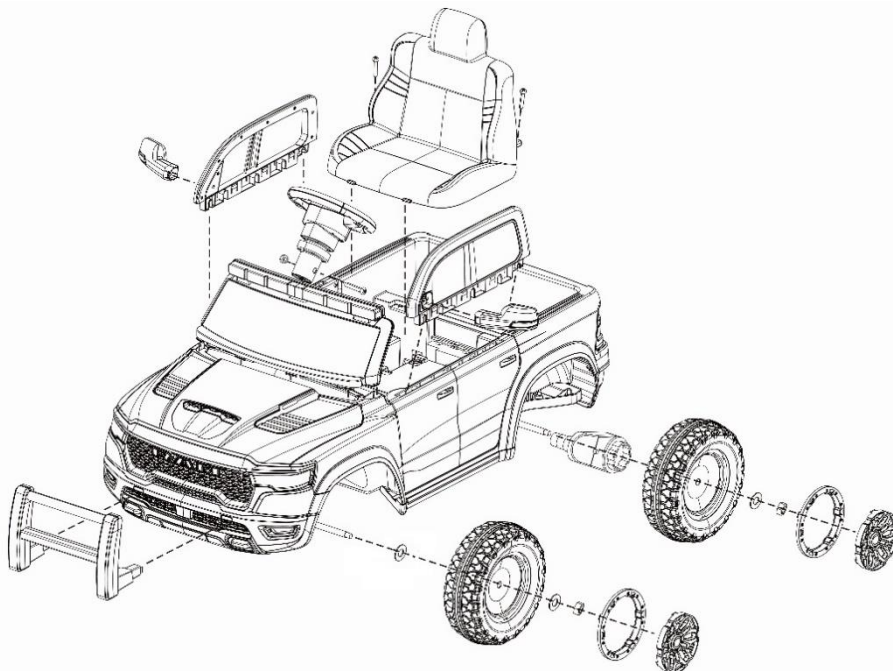

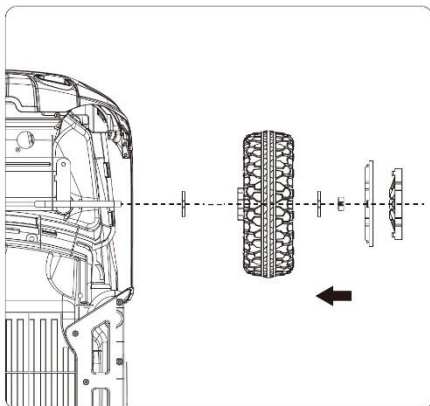

Front Wheel Assembly

- Washer-Wheel-Washer-Nut-wheel cover;
1. Insert one metal washer into the axle.
 2. Put the wheels into the axle.
 3. Insert another metal washer into the axle.
 4. Fix the nut with the M10 wrench.
 5. Put the wheel cover rim (silver), then the black cover onto the wheel.

(Kind notes: If you are buying the 4WD version, the front wheels assembly should be same as below rear-wheel assembly procedure.)

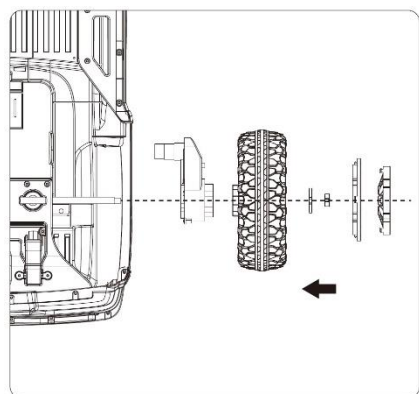

Rear Wheel Assembly

- Motor-Wheel- Washer -Nut-wheel cover;
1. Install motor into the axle and connect the motor-wire.
 2. Put the wheels into the axle.
 3. Insert one metal washer into the axle.
 4. Fix the nut with the M10 wrench.
 5. Put the wheel cover rim (silver), then the black cover onto the wheel.

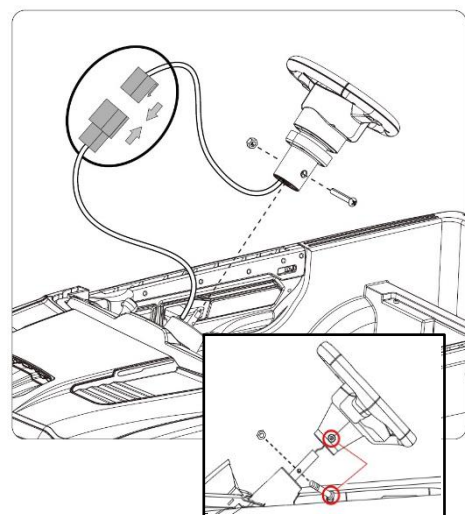

Steering Wheel Assembly

1. Connect the lines of steering wheel with the lines from dashboard;
2. Take off the screw on the steering wheel axle; Slide the steering wheel into the axle;
3. Tighten the lock nut to locking the steering wheel;

Attention! Possible wire damaging! Once the steering wheel is connected, ensure the wire is threaded back through the steering wheel column. Then, you have to match the screw with a screw hole and bolt with a bolt hole. When you attach the steering wheel to the car, they have to align the hole in the steering wheel with a hole on the car's direction bar and only after that to insert the bolt and nut in the appropriate holes.

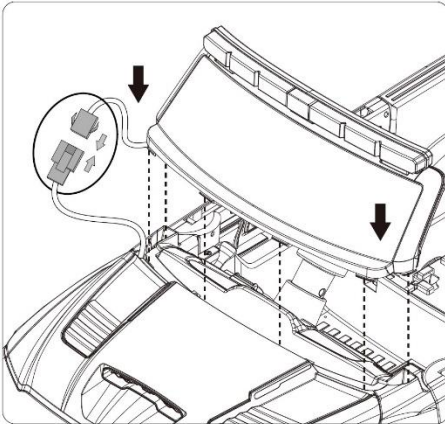

Windshield Assembly
(Type B: ZB618P Police truck version)

1. Connect the wires of police lights with the wires from dashboard hole; Then put the connector and wires into the hole, in order to avoid being cut off during windshield installation.
2. Fit the windshield to car body and press down, make sure it will be in the right way. (There would be a clicking sound when each snap lock well.)

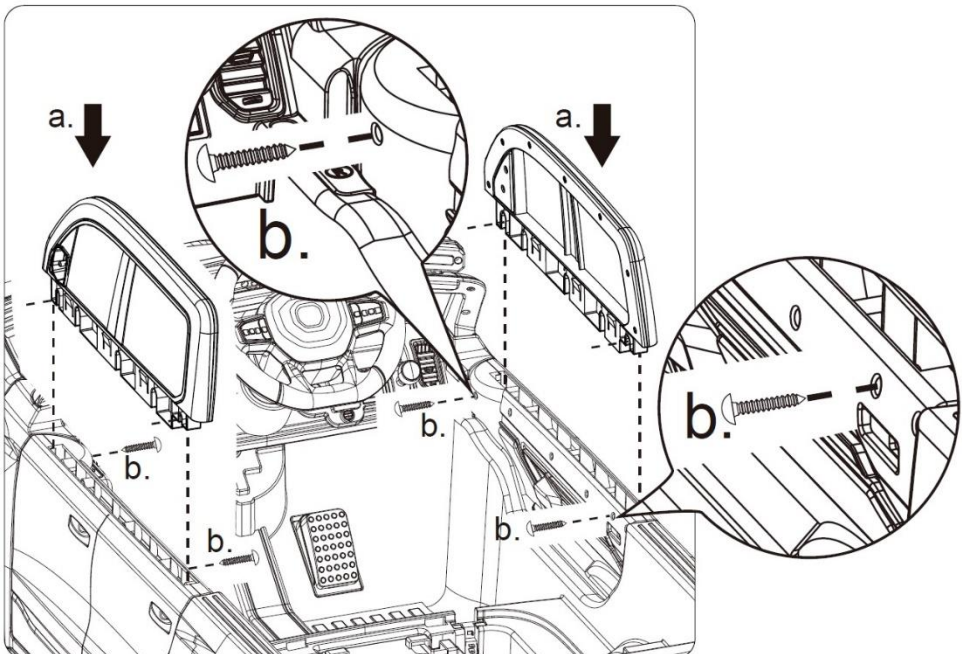

Upper-Window Assembly

1. Insert upper window (a) into door slot. (There would be a clicking sound when each snap lock well.)
2. Insert the screws (b) through the door, and tighten them with a screwdriver. (Kind notes: After installing screws (b), appropriately tighten the screws near them that help stability of the upper window too.)

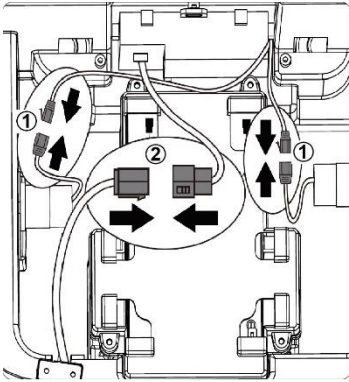

(a)

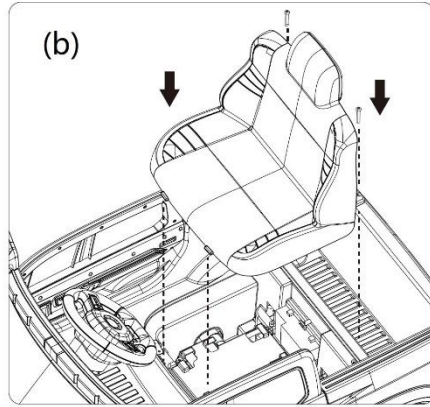

(b)

Seat Assembly

1. First connect motor cable connectors (Black) ①, and then connect the power cable connectors (Orange) ② under the seat. Figure (a) shows an example.
2. Fit the seat as shown in Figure (b) (make sure the seat into the slots on the rear of the vehicle); Insert the screws through the seat back-top and into the vehicle body, and tighten them with a screwdriver.



Mirrors Assembly

1. Fit the mirrors to the car body.

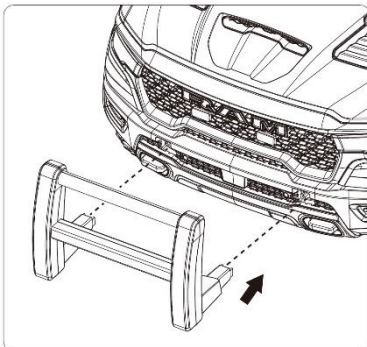

Bumper Assembly (option)

(Bumper is an extra option)

1. Fit the Bumper to car body and press into, make sure it will be in the right way.

Functions:

- (1): Pedal; (2): Forward, stop, back;
- (3): High/low Speed switch;
- (4): Light Switch
or Switch of Manual / Remote
- (5): Power switch; (6): Multi-media;
- (7): Microphone (Extra option for
Police truck version);

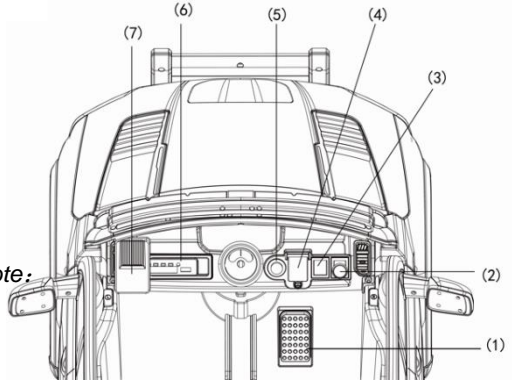

Description for the switch of Manual / Remote:

Under the Manual: the car only can drive by the child;

Under the Remote: the car only can drive by the remote control;

WARNING! - The Switch of Manual / Remote only can be adjusted by an adult by screwdriver.

Pictures are for reference only; functions may vary with different model and setting; please adhere to the original products as standard.

Multi-media Functions:

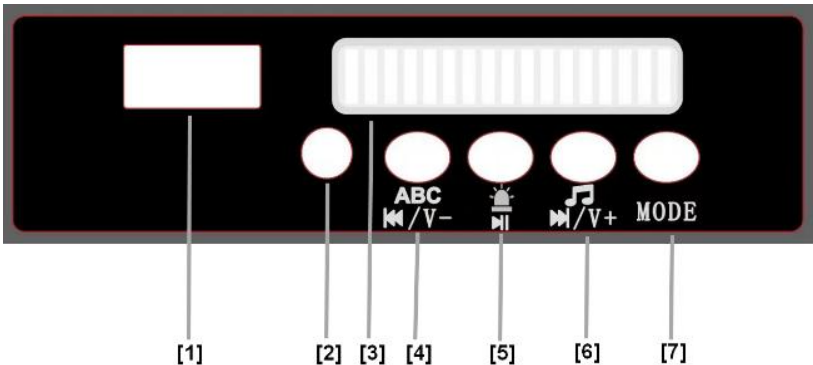

- [1] Socket for Flash Drives
- [2] Microphone input for police truck version (Extra option)
- [3] Power Display
- [4] Education (Pressing for a longer time to lower the volume)
- [5] Police siren and lights for police truck version
- [6] Music (Pressing for a longer time to Higher the volume)
- [7] Model choose (MP3, Flash Drives, or Mobile wireless connection via YJ-BTcar)

Pictures are for reference only; functions may vary with different model and setting; please adhere to the original products as standard.

This remote must be used by adult only.

Remote control first. When the remote control is on, foot pedal is not workable.

Operation Manual:

Take out the remote control, Open the battery compartment on the back of the remote control and add two AAA LRO3 alkaline batteries. Pay attention to the polarity of the batteries. When the alignment light and speed indicator light up, it indicates that the battery installed is correct. This product does not provide dry batteries.

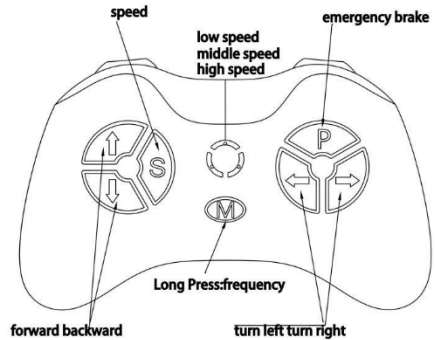

<Button Description >

1) Long press on the frequency key(M) 2-4 seconds, Low speed LED light flashing. Turn on the power of the car, Low speed LED light keep flashing to long lighting, then frequency bind succeed. If the frequency bind failed (Low speed LED light flashing), remove the battery and repeat steps.

“▲” Forward; “▼” Back; “◀” Turn Left; “▶” Turn Right; P: Press to brake; S: Speed: press to change speed (low, middle and high speed).

2) “P” Brake button: Press it to stop moving; press it again to move.

3) “S” Speed selection key and speed indication: used to select speed of the car. Press the key once to switch the speed once. 3 speeds are cyclically switched, and the switching sequence is: low-medium-high. The speed indicator is arranged from top to bottom on the remote control: high-speed lamp, medium-speed lamp, low-speed lamp; when switching to one speed, the corresponding indicator lamp will light up. Note: The speed grade changes only when moving forward

4) Forward/backward keys: used for forward and backward movement control. When one of the keys is pressed, the moving speed will slowly increase to reach the set speed level. Therefore, children will not have a sudden impact.

5) Left turn/right turn key: used for left and right direction control.

Note: without operation after 10 seconds, indication light will off into power saving mode.



Warning! The remote control is not a toy. It is for the adult use only, and should not be used by a child. A close adult supervision is always required. Reception range may change significantly with weather, battery, and other environmental conditions.

- non-rechargeable batteries are not to be recharged;
- different types of batteries or new and used batteries are not to be mixed;
- batteries are to be inserted with the correct polarity (+ and –);
- exhausted batteries are to be removed from the toy;
- the supply terminals are not to be short-circuited.
- for the remote control, the rechargeable batteries should be charged under adult supervision

Pictures are for reference only; functions may vary with different model and setting; please adhere to the original products as standard.

 **Warning!**

- **ONLY an adult is allowed charge and recharge the battery!**
- **This product with Charging Protection: when charging, all functions will be cut off.**

- Battery polarity cannot be reversed. Please ensure the red wire is connected to the red battery terminal and the black wire is connected to the black battery terminal.
- The POWER SWITCH must be turned in OFF position when charging.
- Before the first use, it recommended to charge the battery for 4-6 hours, but not more than 10 hours.
- When the vehicle begins to run slowly, recharge the battery.
- After each use or once a month minimum recharge time as 8 to 12 hours, less than 20 hours at most. Failure to charge the battery as directed will cause permanent damage to battery and will void warranty.
- Use the only rechargeable battery and charger supplied with your vehicle. NEVER substitute the battery or the charger with another brand. Using another battery or charger may cause a fire or explosion.
- Do not use the battery or charger for any other product.
- The charger may feel warm during charging. If excessively hot, unplug and replace.

Battery charger used with the electric toy shall be regularly examined for damage to the supply cord, plug, enclosure or other parts, and in the event of damage, it shall not be used until the damage has been repaired.

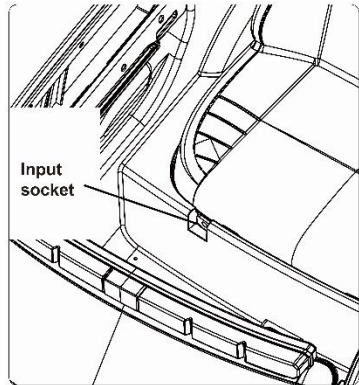

1. Plug the charger port into the input socket.
2. Plug the charger plug into a wall outlet. The battery will begin charging.
3. Unplug the charger when the battery is fully charged.

Battery Disposal

- **Dead battery:** it eventually loses the ability to hold a charge. Depending on the amount of use, and varying conditions, the battery should operate for one to three years.
- **Important!** Lead-acid batteries are completely recyclable. Recycle the dead battery responsibly. It is illegal in most areas to incinerate lead acid batteries or dispose of them in landfills. Dispose of in accordance with all applicable local, state, and national regulations.
- Do not throw the battery away with your regular household waste!

Problem	Possible Cause	Solution
Vehicle does not move	Low Battery	Recharge battery.
	Thermal fuse has tripped	Reset fuse. See <Fuse>
	Battery connector or wires are loose or not connecting properly	Check that the battery connectors are firmly plugged into each other. If wires are loose around the motor Please contact your distributor.
	Battery is dead	Replace battery, please contact your distributor.
	Electrical system is damaged	Please contact your distributor.
	Motor is damaged	Please contact your distributor.
Vehicle does not run very long	Undercharged battery	Check that the battery connectors are firmly plugged into each other when recharging; Charging following the instruction. See <Charging>
	Battery is old	Replace battery, please contact your distributor.
Vehicle runs sluggishly	Low Battery	Recharge battery, please contact your distributor.
	Battery is old	Replace battery, please contact your distributor.
	Vehicle is overload	Reduce weight on vehicle.
	Vehicle is being used in harsh conditions	Avoid using vehicle in harsh conditions. See < safety notice>;
Vehicle needs a push to go forward	Poor contact of wires or connectors	Check that the battery connectors are firmly plugged into each other. If wires are loose around the motor, please contact your distributor.
	"Dead Spot" on motor	A dead spot means the electric power is not being delivered to the terminal connection and the vehicle needs repair. Please contact your distributor.
Loud grinding or clicking noises coming from motor or gear box	Motor or gears are damaged	Please contact your distributor.
Battery will not recharge	Battery connector or adapter connector is loose	Check that the battery connectors are firmly plugged into each other.
	Charger not plugged in	Check that the battery charger is plugged into a working wall outlet.
	Charger is not working	Please contact your distributor.
Charger feels warm when recharging	This is normal and not a cause for concern	See <Charging>.

Completely read through this manual and the troubleshooting guide table before calling. *If you still need more help, please contact your distributor.*

WARNING!

- **Park the vehicle indoors or cover it with a tarp to protect it from wet weather.**
- **Do not leave the vehicle in the sun for long periods of time or fading may occur.**
- **Store in shade or cover with tarp.**
- **Do not wash the vehicle with a hose.**
- **Do not wash the vehicle with soap and water.**
- **Only use the battery specified by the manufacturer**
- **Only use the charger specified by the manufacturer.**

- It is parents' responsibility to check main parts of the toy before using, must regularly examine for potential hazard, such as the battery, charge, cable or cord, plug, screws are fastening enclosure of other parts and that in the event of such damage, the toy must not be used until that damage had been properly removed.
- Make sure the plastic parts of the vehicle are not cracked or broken.
- Occasionally use lightweight oil to lubricate moving parts such as wheels and steering linkage. Do not use oil on plastic which no lubrication is required.
- Keep the vehicle away from sources of heat, such as stoves and heaters. Plastic parts may melt.
- Recharge the battery after each use. Only an adult can handle the battery. Recharge the battery at least once a month when unused for more than a month.
- Do not drive the vehicle in rainy or snowy weather. Water will damage the motor, electric system and battery.
- Clean the vehicle with a soft, dry cloth. To restore shine to plastic parts, use a non-wax furniture polish. Do not use car wax. Do not use abrasive cleaners.
- When not using, all the electrical source should be turn off. Turn off the power switch and disconnect the battery connection.

Fuse

The battery features a thermal self-resetting fuse that will automatically trip and cut off all power to the vehicle if the motor, electric system or battery is overloaded. In that case, it will cut off the power automatically, unit is turned OFF for 20 seconds and then turned ON again. If the thermal fuse trips repeatedly during normal use, the vehicle may need repair. Contact your distributor please.

To avoid losing power, please follow below guidelines:

- Do not overload the vehicle.
- Do not tow anything behind the vehicle.
- Do not drive on steep slopes.
- Do not drive into fixed objects, which may cause the wheels to spin, causing the motor to overheat.
- Do not drive in very hot weather, components may overheat.
- Do not allow water or other liquids to come in contact with the battery or other electric components.
- Do not tamper with the electric system. Doing so may create a short, causing the fuse to trip.

Our products are suitable for
ASTM F963; GB6675 and GB19865; EN71 and EN62115 standard.